

# Bucha Cilíndrica THEC- AC em mm

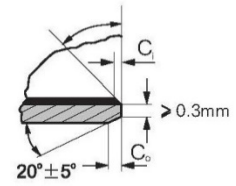
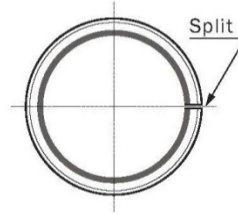
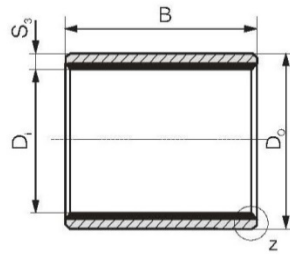

Detail z

Código	Di (mm)	Do (mm)	B (mm)	Alojamento	Eixo	Di máx. em H7 (mm)	Di min em H7 (mm)
0203	2	3.5	3	H6	h6	2.048	2
0205	2	3.5	5	H6	h6	2.048	2
0303	3	4.5	3	H6	h6	3.048	3
0305	3	4.5	5	H6	h6	3.048	3
0306	3	4.5	6	H6	h6	3.048	3
0403	4	5.5	3	H6	h6	4.048	4
0404	4	5.5	4	H6	h6	4.048	4
0406	4	5.5	6	H6	h6	4.048	4
0410	4	5.5	10	H6	h6	4.048	4
0505	5	7	5	H7	f7	5.055	4.99
0508	5	7	8	H7	f7	5.055	4.99
0510	5	7	10	H7	f7	5.055	4.99
0604	6	8	4	H7	f7	6.055	5.99
0606	6	8	6	H7	f7	6.055	5.99
0608	6	8	8	H7	f7	6.055	5.99
0610	6	8	10	H7	f7	6.055	5.99
0705	7	9	5	H7	f7	7.055	6.99
0710	7	9	10	H7	f7	7.055	6.99
0806	8	10	6	H7	f7	8.055	7.99
0808	8	10	8	H7	f7	8.055	7.99
0810	8	10	10	H7	f7	8.055	7.99
0812	8	10	12	H7	f7	8.055	7.99
1006	10	12	6	H7	f7	10.058	9.99
1008	10	12	8	H7	f7	10.058	9.99

Código	Di (mm)	Do (mm)	B (mm)	Alojamento	Eixo	Di máx. em H7 (mm)	Di min em H7 (mm)
1010	10	12	10	H7	f7	10.058	9.99
1012	10	12	12	H7	f7	10.058	9.99
1015	10	12	15	H7	f7	10.058	9.99
1020	10	12	20	H7	f7	10.058	9.99
1208	12	14	8	H7	f7	12.058	11.99
1210	12	14	10	H7	f7	12.058	11.99
1212	12	14	12	H7	f7	12.058	11.99
1215	12	14	15	H7	f7	12.058	11.99
1220	12	14	20	H7	f7	12.058	11.99
1225	12	14	25	H7	f7	12.058	11.99
1310	13	15	10	H7	f7	13.058	12.99
1320	13	15	20	H7	f7	13.058	12.99
1405	14	16	5	H7	f7	14.058	13.99
1410	14	16	10	H7	f7	14.058	13.99
1412	14	16	12	H7	f7	14.058	13.99
1415	14	16	15	H7	f7	14.058	13.99
1420	14	16	20	H7	f7	14.058	13.99
1425	14	16	25	H7	f7	14.058	13.99
1510	15	17	10	H7	f7	15.058	14.99
1512	15	17	12	H7	f7	15.058	14.99
1515	15	17	15	H7	f7	15.058	14.99
1520	15	17	20	H7	f7	15.058	14.99
1525	15	17	25	H7	f7	15.058	14.99
1610	16	18	10	H7	f7	16.058	15.99
1612	16	18	12	H7	f7	16.058	15.99
1615	16	18	15	H7	f7	16.058	15.99
1620	16	18	20	H7	f7	16.058	15.99
1625	16	18	25	H7	F7	16.058	15.99
1720	17	19	20	H7	f7	17.061	16.99
1810	18	20	10	H7	f7	18.061	17.99
1815	18	20	15	H7	f7	18.061	17.99
1820	18	20	20	H7	f7	18.061	17.99

Código	Di (mm)	Do (mm)	B (mm)	Alojamento	Eixo	Di máx. em H7 (mm)	Di min em H7 (mm)
1825	18	20	25	H7	f7	18.061	17.99
2010	20	23	10	H7	f7	20.071	19.99
2015	20	23	15	H7	f7	20.071	19.99
2020	20	23	20	H7	f7	20.071	19.99
2025	20	23	25	H7	f7	20.071	19.99
2030	20	23	30	H7	f7	20.071	19.99
2215	22	25	15	H7	f7	22.071	21.99
2220	22	25	20	H7	f7	22.071	21.99
2225	22	25	25	H7	f7	22.071	21.99
2230	22	25	30	H7	f7	22.071	21.99
2415	24	27	15	H7	f7	24.071	23.99
2420	24	27	20	H7	f7	24.071	23.99
2425	24	27	25	H7	f7	24.071	23.99
2430	24	27	30	H7	f7	24.071	23.99
2515	25	28	15	H7	f7	25.071	24.99
2520	25	28	20	H7	f7	25.071	24.99
2525	25	28	25	H7	f7	25.071	24.99
2530	25	28	30	H7	f7	25.071	24.99
2550	25	28	50	H7	f7	25.071	24.99
2815	28	32	15	H7	f7	28.085	27.99
2820	28	32	20	H7	f7	28.085	27.99
2825	28	32	25	H7	f7	28.085	27.99
3010	30	34	10	H7	f7	30.085	29.99
3015	30	34	15	H7	f7	30.085	29.99
3020	30	34	20	H7	f7	30.085	29.99
3025	30	34	25	H7	f7	30.085	29.99
3030	30	34	30	H7	f7	30.085	29.99
3040	30	34	30	H7	f7	30.085	29.99
3220	32	36	20	H7	f7	32.085	31.99
3230	32	36	30	H7	f7	32.085	31.99
3240	32	36	40	H7	f7	32.085	31.99
3520	35	39	20	H7	f7	35.085	34.99

Código	Di (mm)	Do (mm)	B (mm)	Alojamento	Eixo	Di máx. em H7 (mm)	Di min em H7 (mm)
3530	35	39	30	H7	f7	35.085	34.99
3535	35	39	35	H7	f7	35.085	34.99
3540	35	39	40	H7	f7	35.085	34.99
3550	35	39	50	H7	f7	35.085	34.99
3720	37	41	20	H7	f7	37.085	36.99
4020	40	44	20	H7	f7	40.085	39.99
4030	40	44	30	H7	f7	40.085	39.99
4040	40	44	40	H7	f7	40.085	39.99
4050	40	44	50	H7	f7	40.085	39.99
4520	45	50	20	H7	f7	45.105	44.99
4530	45	50	30	H7	f7	45.105	44.99
4540	45	50	40	H7	f7	45.105	44.99
4545	45	50	45	H7	f7	45.105	44.99
4550	45	50	50	H7	f7	45.105	44.99
5020	50	55	20	H7	f7	50.11	49.99
5030	50	55	30	H7	f7	50.11	49.99
5040	50	55	40	H7	f7	50.11	49.99
5050	50	55	50	H7	f7	50.11	49.99
5060	50	55	60	H7	f7	50.11	49.99
5520	55	60	20	H7	f7	55.11	54.99
5525	55	60	25	H7	f7	55.11	54.99
5530	55	60	30	H7	f7	55.11	54.99
5540	55	60	40	H7	f7	55.11	54.99
5550	55	60	50	H7	f7	55.11	54.99
5555	55	60	55	H7	f7	55.11	54.99
5560	55	60	60	H7	f7	55.11	54.99
6020	60	65	20	H7	f7	60.11	59.99
6030	60	65	30	H7	f7	60.11	59.99
6040	60	65	40	H7	f7	60.11	59.99
6050	60	65	50	H7	f7	60.11	59.99
6060	60	65	60	H7	f7	60.11	59.99
6070	60	65	70	H7	f7	60.11	59.99

Código	Di (mm)	Do (mm)	B (mm)	Alojamento	Eixo	Di máx. em H7 (mm)	Di min em H7 (mm)
6530	65	70	30	H7	f7	65.11	64.99
6550	65	70	50	H7	f7	65.11	64.99
6570	65	70	70	H7	f7	65.11	64.99
7040	70	75	40	H7	f7	70.11	69.99
7070	70	75	70	H7	f7	70.11	69.99
7560	75	80	60	H7	f7	75.11	74.99
7580	75	80	80	H7	f7	75.11	74.99
8040	80	85	40	H7	h8	80.155	80.02
8060	80	85	60	H7	h8	80.155	80.02
8080	80	85	80	H7	h8	80.155	80.02
80100	80	85	100	H7	h8	80.155	80.02
8530	85	90	30	H7	h8	85.155	85.02
8560	85	90	60	H7	h8	85.155	85.02
85100	85	90	100	H7	h8	85.155	85.02
9060	90	95	60	H7	h8	90.155	90.02
90100	90	95	100	H7	h8	90.155	90.02
9560	95	100	60	H7	h8	95.155	95.02
95100	95	100	100	H7	h8	95.155	95.02
10050	100	105	50	H7	h8	100.155	100.02
10060	100	105	60	H7	h8	100.155	100.02
100115	100	105	115	H7	h8	100.155	100.02
10560	105	110	60	H7	h8	105.155	105.02
10580	105	110	80	H7	h8	105.155	105.02
105115	105	110	115	H7	h8	105.155	105.02
11060	110	115	60	H7	h8	110.155	110.02
11080	110	115	80	H7	h8	110.155	110.02
110115	110	115	115	H7	h8	110.155	110.02
12060	120	125	60	H7	h8	120.210	120.07
12080	120	125	80	H7	h8	120.210	120.07
120110	120	125	110	H7	h8	120.210	120.07
12560	125	130	60	H7	h8	125.210	125.07
125100	125	130	100	H7	h8	125.210	125.07



# Bucha Cilíndrica THEC-AC em polegadas

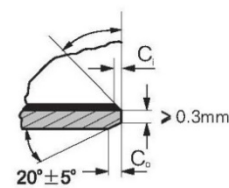
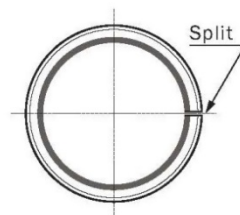
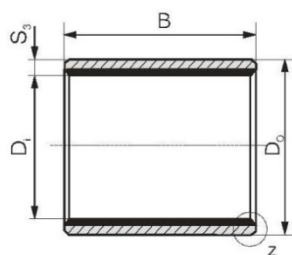

Detail z

Código	Di (pol)	Do (pol)	B (pol)	Eixo min	Eixo máx	Alojamento máx	Alojamento min	Di máx. em H7 (mm)	Di min em H7 (mm)
02IB02	1/8	3/16	0.125	0.1243	0.1236	0.1878	0.1873	0.1268	0.1243
02IB03	1/8	3/16	0.188	0.1243	0.1236	0.1878	0.1873	0.1268	0.1243
025IB025	5/32	7/32	0.154	0.1554	0.1547	0.2191	0.2186	0.1581	0.1556
025IB04	5/32	7/32	0.25	0.1554	0.1547	0.2191	0.2186	0.1581	0.1556
03IB03	3/16	1/4	0.188	0.1865	0.1858	0.2503	0.2497	0.1893	0.1867
03IB04	3/16	1/4	0.25	0.1865	0.1858	0.2503	0.2497	0.1893	0.1867
03IB06	3/16	1/4	0.375	0.1865	0.1858	0.2503	0.2497	0.1893	0.1867
04IB04	1/4	5/16	0.25	0.249	0.2481	0.3128	0.3122	0.2518	0.2492
04IB06	1/4	5/16	0.375	0.249	0.2481	0.3128	0.3122	0.2518	0.2492
05IB06	5/16	3/8	0.375	0.3115	0.3106	0.3753	0.3747	0.3143	0.3117
05IB08	5/16	3/8	0.5	0.3115	0.3106	0.3753	0.3747	0.3143	0.3117
06IB03	3/8	15/32	0.188	0.374	0.3731	0.4691	0.4684	0.3769	0.3742
06IB04	3/8	15/32	0.25	0.374	0.3731	0.4691	0.4684	0.3769	0.3742
06IB06	3/8	15/32	0.375	0.374	0.3731	0.4691	0.4684	0.3769	0.3742
06IB08	3/8	15/32	0.5	0.374	0.3731	0.4691	0.4684	0.3769	0.3742
06IB10	3/8	15/32	0.625	0.374	0.3731	0.4691	0.4684	0.3769	0.3742
06IB12	3/8	15/32	0.75	0.374	0.3731	0.4691	0.4684	0.3769	0.3742
07IB08	7/16	17/32	0.5	0.4365	0.4355	0.5316	0.5309	0.4394	0.4367
07IB12	7/16	17/32	0.75	0.4365	0.4355	0.5316	0.5309	0.4394	0.4367
08IB04	1/2	19/32	0.25	0.499	0.498	0.5941	0.5934	0.5019	0.4992
08IB06	1/2	19/32	0.375	0.499	0.498	0.5941	0.5934	0.5019	0.4992
08IB08	1/2	19/32	0.5	0.499	0.498	0.5941	0.5934	0.5019	0.4992
08IB10	1/2	19/32	0.625	0.499	0.498	0.5941	0.5934	0.5019	0.4992

Código	Di (pol)	Do (pol)	B (pol)	Eixo min	Eixo máx	Alojamento máx	Alojamento min	Di máx. em H7 (mm)	Di min em H7 (mm)
08IB12	1/2	19/32	0.75	0.499	0.498	0.5941	0.5934	0.5019	0.4992
08IB14	1/2	19/32	0.875	0.499	0.498	0.5941	0.5934	0.5019	0.4992
09IB06	9/16	21/32	0.375	0.5615	0.5605	0.6566	0.6559	0.5644	0.5617
09IB08	9/16	21/32	0.5	0.5615	0.5605	0.6566	0.6559	0.5644	0.5617
09IB10	9/16	21/32	0.625	0.5615	0.5605	0.6566	0.6559	0.5644	0.5617
09IB12	9/16	21/32	0.75	0.5615	0.5605	0.6566	0.6559	0.5644	0.5617
10IB04	5/8	23/32	0.25	0.624	0.623	0.7192	0.7184	0.627	0.6242
10IB08	5/8	23/32	0.5	0.624	0.623	0.7192	0.7184	0.627	0.6242
10IB12	5/8	23/32	0.75	0.624	0.623	0.7192	0.7184	0.627	0.6242
10IB14	5/8	23/32	0.875	0.624	0.623	0.7192	0.7184	0.627	0.6242
10IB16	5/8	23/32	1	0.624	0.623	0.7192	0.7184	0.627	0.6242
11IB14	11/16	25/32	0.875	0.6865	0.6855	0.7817	0.7809	0.6895	0.6867
12IB04	3/4	7/8	0.25	0.7491	0.7479	0.8755	0.8747	0.7525	0.7493
12IB06	3/4	7/8	0.375	0.7491	0.7479	0.8755	0.8747	0.7525	0.7493
12IB08	3/4	7/8	0.5	0.7491	0.7479	0.8755	0.8747	0.7525	0.7493
12IB10	3/4	7/8	0.625	0.7491	0.7479	0.8755	0.8747	0.7525	0.7493
12IB12	3/4	7/8	0.75	0.7491	0.7479	0.8755	0.8747	0.7525	0.7493
12IB16	3/4	7/8	1	0.7491	0.7479	0.8755	0.8747	0.7525	0.7493
14IB04	7/8	1	0.25	0.8741	0.8729	1.0005	0.9997	0.8775	0.8743
14IB06	7/8	1	0.375	0.8741	0.8729	1.0005	0.9997	0.8775	0.8743
14IB12	7/8	1	0.75	0.8741	0.8729	1.0005	0.9997	0.8775	0.8743
14IB14	7/8	1	0.875	0.8741	0.8729	1.0005	0.9997	0.8775	0.8743
14IB16	7/8	1	1	0.8741	0.8729	1.0005	0.9997	0.8775	0.8743
14IB20	7/8	1	1.25	0.8741	0.8729	1.0005	0.9997	0.8775	0.8743
16IB06	1	1 1/8	0.375	0.9991	0.9979	1.1256	1.1246	1.0026	0.9992
16IB08	1	1 1/8	0.5	0.9991	0.9979	1.1256	1.1246	1.0026	0.9992
16IB12	1	1 1/8	0.75	0.9991	0.9979	1.1256	1.1246	1.0026	0.9992
16IB16	1	1 1/8	1	0.9991	0.9979	1.1256	1.1246	1.0026	0.9992
16IB20	1	1 1/8	1.25	0.9991	0.9979	1.1256	1.1246	1.0026	0.9992
16IB24	1	1 1/8	1.5	0.9991	0.9979	1.1256	1.1246	1.0026	0.9992
18IB06	1 1/8	1 9/32	0.375	1.1238	1.1226	1.2818	1.2808	1.1278	1.124
18IB10	1 1/8	1 9/32	0.625	1.1238	1.1226	1.2818	1.2808	1.1278	1.124
18IB12	1 1/8	1 9/32	0.75	1.1238	1.1226	1.2818	1.2808	1.1278	1.124



Código	Di (pol)	Do (pol)	B (pol)	Eixo min	Eixo máx	Alojamento máx	Alojamento min	Di máx. em H7 (mm)	Di min em H7 (mm)
18IB16	1 1/8	1 9/32	1	1.1238	1.1226	1.2818	1.2808	1.1278	1.124
20IB06	1 1/4	1 13/32	0.375	1.2488	1.2472	1.4068	1.4058	1.2528	1.249
20IB12	1 1/4	1 13/32	0.75	1.2488	1.2472	1.4068	1.4058	1.2528	1.249
20IB14	1 1/4	1 13/32	0.875	1.2488	1.2472	1.4068	1.4058	1.2528	1.249
20IB16	1 1/4	1 13/32	1	1.2488	1.2472	1.4068	1.4058	1.2528	1.249
20IB20	1 1/4	1 13/32	1.25	1.2488	1.2472	1.4068	1.4058	1.2528	1.249
20IB28	1 1/4	1 13/32	1.75	1.2488	1.2472	1.4068	1.4058	1.2528	1.249
22IB12	1 3/8	1 17/32	0.75	1.3738	1.3722	1.5318	1.5308	1.3778	1.374
22IB16	1 3/8	1 17/32	1	1.3738	1.3722	1.5318	1.5308	1.3778	1.374
22IB24	1 3/8	1 17/32	1.5	1.3738	1.3722	1.5318	1.5308	1.3778	1.374
22IB28	1 3/8	1 17/32	1.75	1.3738	1.3722	1.5318	1.5308	1.3778	1.374
24IB08	1 1/2	1 21/32	0.5	1.4988	1.4972	1.6568	1.6558	1.5028	1.499
24IB16	1 1/2	1 21/32	1	1.4988	1.4972	1.6568	1.6558	1.5028	1.499
24IB18	1 1/2	1 21/32	1.125	1.4988	1.4972	1.6568	1.6558	1.5028	1.499
24IB20	1 1/2	1 21/32	1.25	1.4988	1.4972	1.6568	1.6558	1.5028	1.499
24IB24	1 1/2	1 21/32	1.5	1.4988	1.4972	1.6568	1.6558	1.5028	1.499
24IB32	1 1/2	1 21/32	2	1.4988	1.4972	1.6568	1.6558	1.5028	1.499
26IB16	1 5/8	1 25/32	1	1.6238	1.6222	1.7818	1.7808	1.6278	1.624
26IB24	1 5/8	1 25/32	1.5	1.6238	1.6222	1.7818	1.7808	1.6278	1.624
28IB28	1 3/4	1 15/16	1.75	1.7487	1.7471	1.9381	1.9371	1.7535	1.7489
28IB32	1 3/4	1 15/16	2	1.7487	1.7471	1.9381	1.9371	1.7535	1.7489
30IB12	1 7/8	2 1/16	0.75	1.8737	1.8721	2.0633	2.0621	1.8787	1.8739
30IB16	1 7/8	2 1/16	1	1.8737	1.8721	2.0633	2.0621	1.8787	1.8739
30IB30	1 7/8	2 1/16	1.875	1.8737	1.8721	2.0633	2.0621	1.8787	1.8739
30IB36	1 7/8	2 1/16	2.25	1.8737	1.8721	2.0633	2.0621	1.8787	1.8739
32IB08	2	2 3/16	0.5	1.9987	1.9969	2.1883	2.1871	2.0037	1.9989
32IB16	2	2 3/16	1	1.9987	1.9969	2.1883	2.1871	2.0037	1.9989
32IB24	2	2 3/16	1.5	1.9987	1.9969	2.1883	2.1871	2.0037	1.9989
32IB28	2	2 3/16	1.75	1.9987	1.9969	2.1883	2.1871	2.0037	1.9989
32IB32	2	2 3/16	2	1.9987	1.9969	2.1883	2.1871	2.0037	1.9989
32IB40	2	2 3/16	2.5	1.9987	1.9969	2.1883	2.1871	2.0037	1.9989

Código	Di (pol)	Do (pol)	B (pol)	Eixo min	Eixo máx	Alojamento máx	Alojamento min	Di máx. em H7 (mm)	Di min em H7 (mm)
34IB08	2 1/8	2 5/16	0.5	2.1257	2.1239	2.313	2.3118	2.1326	2.1262
34IB12	2 1/8	2 5/16	0.75	2.1257	2.1239	2.313	2.3118	2.1326	2.1262
34IB16	2 1/8	2 5/16	1	2.1257	2.1239	2.313	2.3118	2.1326	2.1262
34IB24	2 1/8	2 5/16	1.5	2.1257	2.1239	2.313	2.3118	2.1326	2.1262
34IB28	2 1/8	2 5/16	1.75	2.1257	2.1239	2.313	2.3118	2.1326	2.1262
34IB32	2 1/8	2 5/16	2	2.1257	2.1239	2.313	2.3118	2.1326	2.1262
34IB48	2 1/8	2 5/16	3	2.1257	2.1239	2.313	2.3118	2.1326	2.1262
34IB64	2 1/8	2 5/16	4	2.1257	2.1239	2.313	2.3118	2.1326	2.1262
36IB28	2 1/4	2 7/16	1.75	2.2507	2.2489	2.4377	2.4365	2.2573	2.2509
36IB32	2 1/4	2 7/16	2	2.2507	2.2489	2.4377	2.4365	2.2573	2.2509
36IB36	2 1/4	2 7/16	2.25	2.2507	2.2489	2.4377	2.4365	2.2573	2.2509
36IB40	2 1/4	2 7/16	2.5	2.2507	2.2489	2.4377	2.4365	2.2573	2.2509
36IB48	2 1/4	2 7/16	3	2.2507	2.2489	2.4377	2.4365	2.2573	2.2509
36IB56	2 1/4	2 7/16	3.5	2.2507	2.2489	2.4377	2.4365	2.2573	2.2509
36IB60	2 1/4	2 7/16	3.75	2.2507	2.2489	2.4377	2.4365	2.2573	2.2509
36IB64	2 1/4	2 7/16	4	2.2507	2.2489	2.4377	2.4365	2.2573	2.2509
36IB72	2 1/4	2 7/16	4.5	2.2507	2.2489	2.4377	2.4365	2.2573	2.2509
40IB16	2 1/2	2 11/16	1	2.5011	2.4993	2.6881	2.6869	2.5077	2.5013
40IB26	2 1/2	2 11/16	1.625	2.5011	2.4993	2.6881	2.6869	2.5077	2.5013
40IB32	2 1/2	2 11/16	2	2.5011	2.4993	2.6881	2.6869	2.5077	2.5013
40IB40	2 1/2	2 11/16	2.5	2.5011	2.4993	2.6881	2.6869	2.5077	2.5013
40IB48	2 1/2	2 11/16	3	2.5011	2.4993	2.6881	2.6869	2.5077	2.5013
40IB56	2 1/2	2 11/16	3.5	2.5011	2.4993	2.6881	2.6869	2.5077	2.5013
40IB60	2 1/2	2 11/16	3.75	2.5011	2.4993	2.6881	2.6869	2.5077	2.5013
40IB64	2 1/2	2 11/16	4	2.5011	2.4993	2.6881	2.6869	2.5077	2.5013
40IB72	2 1/2	2 11/16	4.5	2.5011	2.4993	2.6881	2.6869	2.5077	2.5013
40IB76	2 1/2	2 11/16	4.75	2.5011	2.4993	2.6881	2.6869	2.5077	2.5013
44IB32	2 3/4	2 15/16	2	2.75	2.7482	2.937	2.9358	2.7566	2.7502
44IB36	2 3/4	2 15/16	2.25	2.75	2.7482	2.937	2.9358	2.7566	2.7502
44IB40	2 3/4	2 15/16	2.5	2.75	2.7482	2.937	2.9358	2.7566	2.7502
44IB48	2 3/4	2 15/16	3	2.75	2.7482	2.937	2.9358	2.7566	2.7502
44IB56	2 3/4	2 15/16	3.5	2.75	2.7482	2.937	2.9358	2.7566	2.7502
44IB60	2 3/4	2 15/16	3.75	2.75	2.7482	2.937	2.9358	2.7566	2.7502

Código	Di (pol)	Do (pol)	B (pol)	Eixo min	Eixo máx	Alojamento máx	Alojamento min	Di máx. em H7 (mm)	Di min em H7 (mm)
44IB72	2 3/4	2 15/16	4.5	2.75	2.7482	2.937	2.9358	2.7566	2.7502
44IB76	2 3/4	2 15/16	4.75	2.75	2.7482	2.937	2.9358	2.7566	2.7502
44IB80	2 1/2	2 15/16	5	2.75	2.7482	2.937	2.9358	2.7566	2.7502
48IB32	3	3 3/16	2	3	2.9982	3.1872	3.1858	3.0068	3.0002
48IB36	3	3 3/16	2.25	3	2.9982	3.1872	3.1858	3.0068	3.0002
48IB40	3	3 3/16	2.5	3	2.9982	3.1872	3.1858	3.0068	3.0002
48IB48	3	3 3/16	3	3	2.9982	3.1872	3.1858	3.0068	3.0002
48IB56	3	3 3/16	3.5	3	2.9982	3.1872	3.1858	3.0068	3.0002
48IB60	3	3 3/16	3.75	3	2.9982	3.1872	3.1858	3.0068	3.0002
48IB64	3	3 3/16	4	3	2.9982	3.1872	3.1858	3.0068	3.0002
48IB72	3	3 3/16	4.5	3	2.9982	3.1872	3.1858	3.0068	3.0002
48IB76	3	3 3/16	4.75	3	2.9982	3.1872	3.1858	3.0068	3.0002
48IB80	3	3 3/16	5	3	2.9982	3.1872	3.1858	3.0068	3.0002
52IB32	3 1/4	3 7/16	2	3.25	3.248	3.4372	3.4358	3.2568	3.2502
52IB38	3 1/4	3 7/16	2.375	3.25	3.248	3.4372	3.4358	3.2568	3.2502
52IB40	3 1/4	3 7/16	2.5	3.25	3.248	3.4372	3.4358	3.2568	3.2502
52IB48	3 1/4	3 7/16	3	3.25	3.248	3.4372	3.4358	3.2568	3.2502
52IB56	3 1/4	3 7/16	3.5	3.25	3.248	3.4372	3.4358	3.2568	3.2502
52IB60	3 1/4	3 7/16	3.75	3.25	3.248	3.4372	3.4358	3.2568	3.2502
52IB64	3 1/4	3 7/16	4	3.25	3.248	3.4372	3.4358	3.2568	3.2502
52IB72	3 1/4	3 7/16	4.5	3.25	3.248	3.4372	3.4358	3.2568	3.2502
52IB76	3 1/4	3 7/16	4.75	3.25	3.248	3.4372	3.4358	3.2568	3.2502
52IB80	3 1/4	3 7/16	5	3.25	3.248	3.4372	3.4358	3.2568	3.2502
56IB32	3 1/2	3 11/16	2	3.5	3.4978	3.6872	3.6858	3.5068	3.5002
56IB38	3 1/2	3 11/16	2.375	3.5	3.4978	3.6872	3.6858	3.5068	3.5002
56IB40	3 1/2	3 11/16	2.5	3.5	3.4978	3.6872	3.6858	3.5068	3.5002
56IB48	3 1/2	3 11/16	3	3.5	3.4978	3.6872	3.6858	3.5068	3.5002
56IB56	3 1/2	3 11/16	3.5	3.5	3.4978	3.6872	3.6858	3.5068	3.5002
56IB60	3 1/2	3 11/16	3.75	3.5	3.4978	3.6872	3.6858	3.5068	3.5002
56IB64	3 1/2	3 11/16	4	3.5	3.4978	3.6872	3.6858	3.5068	3.5002
56IB72	3 1/2	3 11/16	4.5	3.5	3.4978	3.6872	3.6858	3.5068	3.5002

Código	Di (pol)	Do (pol)	B (pol)	Eixo min	Eixo máx	Alojamento máx	Alojamento min	Di máx. em H7 (mm)	Di min em H7 (mm)
56B76	3 1/2	3 11/16	4.75	3.5	3.4978	3.6872	3.6858	3.5068	3.5002
58B32	3 5/8	3 13/16	2	3.625	3.6228	3.8122	3.8108	3.6318	3.6252
58B36	3 5/8	3 13/16	2.25	3.625	3.6228	3.8122	3.8108	3.6318	3.6252
58B40	3 5/8	3 13/16	2.5	3.625	3.6228	3.8122	3.8108	3.6318	3.6252
58B48	3 5/8	3 13/16	3	3.625	3.6228	3.8122	3.8108	3.6318	3.6252
58B56	3 5/8	3 13/16	3.5	3.625	3.6228	3.8122	3.8108	3.6318	3.6252
58B60	3 5/8	3 13/16	3.75	3.625	3.6228	3.8122	3.8108	3.6318	3.6252
58B64	3 5/8	3 13/16	4	3.625	3.6228	3.8122	3.8108	3.6318	3.6252
85B72	3 5/8	3 13/16	4.5	3.625	3.6228	3.8122	3.8108	3.6318	3.6252

# Bucha Flangeada THEC-AC em milímetros

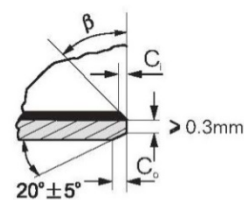
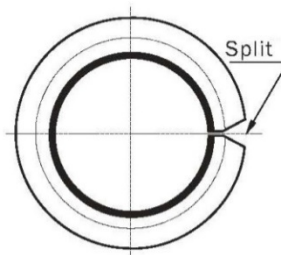
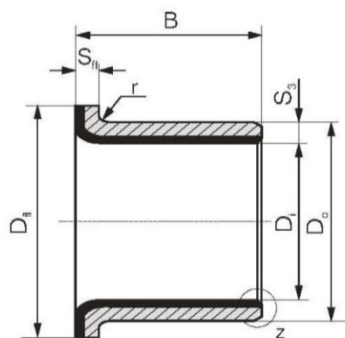

Detail z

Código	Di (mm)	Do (mm)	Sfl (mm)	Dfl (mm)	B (mm)	Alojamento	Eixo	Di máx. em H7 (mm)	Di min em H7 (mm)
0304F	3	4.5	0.75	7	4	H6	h6	3.048	3
0404F	4	5.5	0.75	9	4	H6	h6	4.048	4
0505F	5	7	0.925	10	5	H7	f7	5.055	4.99
0604F	6	8	0.925	12	4	H7	f7	6.055	5.99
0608F	6	8	0.925	12	8	H7	f7	6.055	5.99
0806F	8	10	0.925	15	5.5	H7	f7	8.055	7.99
0808F	8	10	0.925	15	7.5	H7	f7	8.055	7.99
0810F	8	10	0.925	15	9.5	H7	f7	8.055	7.99
1007F	10	12	0.925	18	7	H7	f7	10.058	9.99
1009F	10	12	0.925	18	9	H7	f7	10.058	9.99
1012F	10	12	0.925	18	12	H7	f7	10.058	9.99
1017F	10	12	0.925	18	17	H7	f7	10.058	9.99
1207F	12	14	0.925	20	7	H7	f7	12.058	11.99
1209F	12	14	0.925	20	9	H7	f7	12.058	11.99
1212F	12	14	0.925	20	12	H7	f7	12.058	11.99
1217F	12	14	0.925	20	17	H7	f7	12.058	11.99
1412F	14	16	0.925	22	12	H7	f7	14.058	13.99
1417F	14	16	0.925	22	17	H7	f7	14.058	13.99
1509F	15	17	0.925	23	9	H7	f7	15.058	14.99
1512F	15	17	0.925	23	12	H7	f7	15.058	14.99
1517F	15	17	0.925	23	17	H7	f7	15.058	14.99



# Bucha Flangeada THEC-AC em polegadas

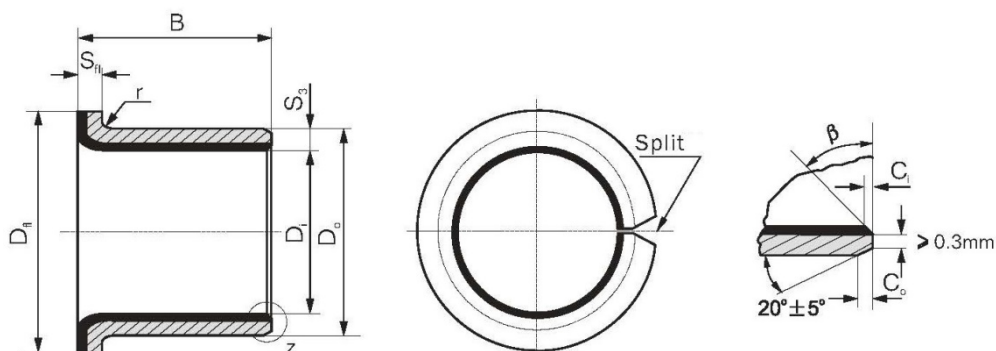

Detail z

Código	Di (pol)	Do (pol)	Sfl (pol)	Dfl (pol)	B (pol)	Eixo Máx (pol)	Eixo Min (pol)	Di máx. (pol)	Di min (pol)
06FIB04	3/8	15/32	0.043	0.6875	0.245	0.4691	0.4684	0.3779	0.3752
06FIB06	3/8	15/32	0.043	0.6875	0.37	0.4691	0.4684	0.3779	0.3752
06FIB08	3/8	15/32	0.043	0.6875	0.495	0.4691	0.4684	0.3779	0.3752
06FIB12	3/8	15/32	0.043	0.6875	0.745	0.4691	0.4684	0.3779	0.3752
08FIB04	1/2	19/32	0.043	0.8125	0.245	0.4691	0.5934	0.5029	0.5002
08FIB06	1/2	19/32	0.043	0.8125	0.37	0.4691	0.5934	0.5029	0.5002
08FIB08	1/2	19/32	0.043	0.8125	0.495	0.4691	0.5934	0.5029	0.5002
08FIB12	1/2	19/32	0.043	0.8125	0.745	0.4691	0.5934	0.5029	0.5002
10FIB06	5/8	23/32	0.043	0.93725	0.37	0.7192	0.7184	0.628	0.6252
10FIB08	5/8	23/32	0.043	0.93725	0.495	0.7192	0.7184	0.628	0.6252
10FIB10	5/8	23/32	0.043	0.93725	0.62	0.7192	0.7184	0.628	0.6252
10FIB12	5/8	23/32	0.043	0.93725	0.745	0.7192	0.7184	0.628	0.6252
12FIB06	3/4	7/8	0.059	1.25	0.37	0.8755	0.8747	0.7534	0.7502
12FIB08	3/4	7/8	0.059	1.25	0.495	0.8755	0.8747	0.7534	0.7502
12FIB12	3/4	7/8	0.059	1.25	0.745	0.8755	0.8747	0.7534	0.7502
12FIB16	3/4	7/8	0.059	1.25	0.995	0.8755	0.8747	0.7534	0.7502
14FIB08	7/8	1	0.059	1.25	0.495	1.0005	0.9997	0.8784	0.8752
14FIB12	7/8	1	0.059	1.25	0.745	1.0005	0.9997	0.8784	0.8752
14FIB16	7/8	1	0.059	1.25	0.995	1.0005	0.9997	0.8784	0.8752
14FIB20	7/8	1	0.059	1.25	1.245	1.0005	0.9997	0.8784	0.8752
16FIB08	1	1 1/8	0.059	1.375	0.495	1.1255	1.1247	1.0034	1.0002

Código	Di (pol)	Do (pol)	Sfl (pol)	Dfl (pol)	B (pol)	Eixo Máx (pol)	Eixo Min (pol)	Di máx. (pol)	Di min (pol)
16FIB12	1	1 1/8	0.059	1.375	0.495	1.1255	1.1247	1.0034	1.0002
16FIB16	1	1 1/8	0.059	1.375	0.995	1.1255	1.1247	1.0034	1.0002
16FIB20	1	1 1/8	0.059	1.375	1.245	1.1255	1.1247	1.0034	1.0002
20FIB16	1 1/4	1 13/32	0.074	1.75	0.995	1.4068	1.4058	1.254	1.2502
20FIB20	1 /14	1 13/32	0.074	1.75	1.245	1.4068	1.4058	1.254	1.2502
20FIB24	1 /14	1 13/32	0.074	1.75	1.495	1.4068	1.4058	1.254	1.2502
24FIB16	1 1/2	1 21/32	0.074	2	0.995	1.6568	1.6558	1.504	1.5002
24FIB24	1 1/2	1 21/32	0.074	2	1.495	1.6568	1.6558	1.504	1.5002
24FIB32	1 1/2	1 21/32	0.074	2	1.995	1.6568	1.6558	1.504	1.5002



# Anel de encosto THEC-AC em milímetros

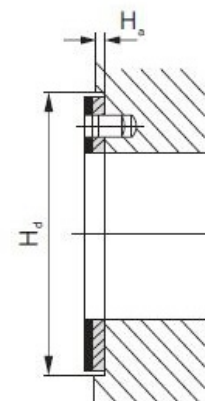
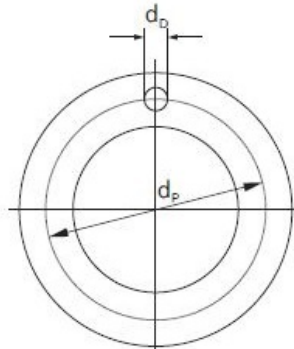
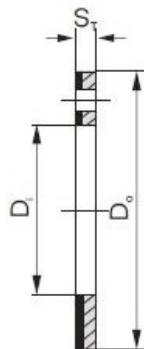

Código	Di (mm)	Do (mm)	ST (mm)	dD (mm)	dP (mm)	Ha max. (mm)
WC 08	10	20	1.5	1.75	15	1.2
WC 10	12	24	1.5	1.75	18	1.2
WC 12	14	26	1.5	2.25	20	1.2
WC 14	16	30	1.5	2.25	22	1.2
WC 16	18	32	1.5	2.25	25	1.2
WC 18	20	36	1.25	3.25	28	1.2
WC 20	22	38	1.25	3.25	30	1.2
WC 22	24	42	1.5	3.25	33	1.2
WC 24	26	44	1.5	3.25	35	1.2
WC 25	28	48	1.5	4.25	38	1.2
WC 30	32	54	1.5	4.25	43	1.2
WC 35	38	62	1.5	4.25	50	1.2
WC 40	42	66	1.5	4.25	54	1.2
WC 45	48	74	2	4.25	61	1.7
WC 50	52	78	2	4.25	65	1.7
WC 60	62	90	2	4.25	76	1.7

# Anel de encosto THEC-AC em polegadas

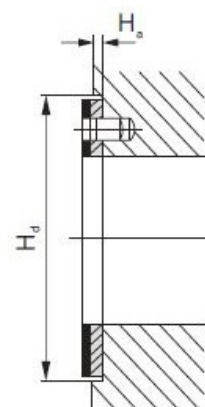
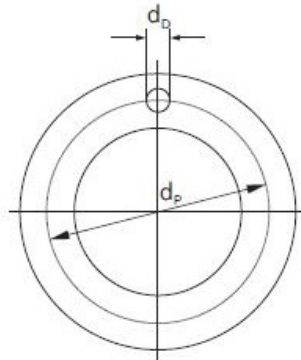
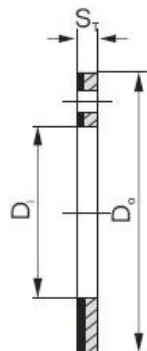

Código	Di (pol)	Do (pol)	ST (pol)	dD (pol)	dP (pol)	Ha max. (pol)
WC IB 06	0.5	0.875	0.0605	0.072	0.687	0.05
WC IB 07	0.562	1	0.0605	0.072	0.781	0.05
WC IB 08	0.625	1.125	0.0605	0.104	0.875	0.05
WC IB 09	0.687	1.187	0.0605	0.104	0.937	0.05
WC IB 10	0.75	1.25	0.0605	0.104	1	0.05
WC IB 11	0.812	1.375	0.0605	0.104	1.094	0.05
WC IB 12	0.875	1.5	0.0605	0.135	1.187	0.05
WC IB 14	1	1.75	0.0605	0.135	1.375	0.05
WC IB 16	1.125	2	0.0605	0.166	1.562	0.05
WC IB 18	1.25	2.125	0.0605	0.166	1.687	0.05
WC IB 20	1.375	2.25	0.0605	0.166	1.812	0.05
WC IB 22	1.5	2.5	0.0605	0.197	2	0.05
WC IB 24	1.625	2.625	0.0605	0.197	2.125	0.05
WC IB 26	1.75	2.75	0.0605	0.197	2.25	0.05
WC IB 28	2	3	0.0915	0.197	2.5	0.08
WC IB 30	2.125	3.125	0.0915	0.197	2.625	0.08
WC IB 32	2.25	3.25	0.0915	0.197	2.75	0.08

## Placas THEC-AC em milímetros

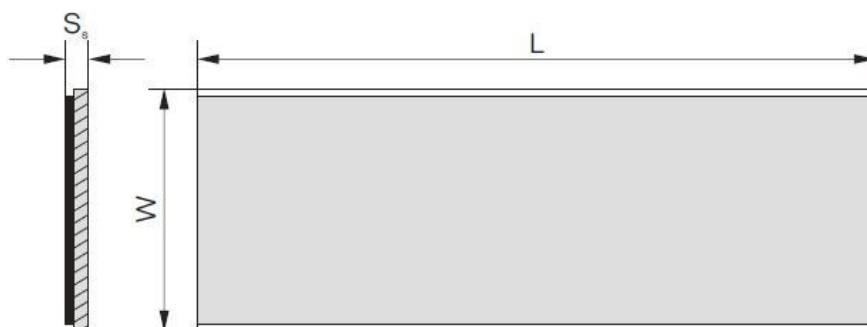
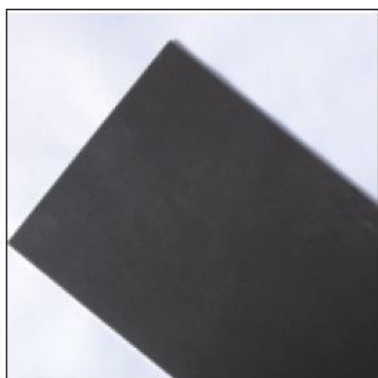

Código	L (mm) $\pm 1$	W (mm) $\pm 1$	Ss (mm) -0,05
SP 07150	500	150	0.72
SP 10215	500	215	0.99
SP 15245	500	245	1.5
SP 20245	500	245	2.0
SP 25245	500	245	2.5
SP 30245	500	245	3.0